

# DEPOSITORS

## Piston and rotary depositors

### MOULDING

Piston and rotary depositors conceived for the accurate dosing of chocolate and cream into the moulds.



MLP PISTON DEPOSITOR

- Touch screen panel
- Single or double, fixed or mobile head versions available
- Side extraction as a standard for easy cleaning
- Piston blocks easily replaceable
- Stand alone version available
- It can be easily integrated on new or existing plants



MLR ROTARY DEPOSITOR

- Touch screen
- Single or double, fixed or mobile head versions available
- Extractable as a standard for easy cleaning
- Stainless steel tank/rotor/stator/valves
- No gaskets needed
- Stand alone version available
- It can be easily integrated on new or existing plants

STANDARD FEATURES

MLP

Servo-driven extractable depositor for cleaning and maintenance

Weight-controlled dosing of products in the moulds is achieved through adjustment of the pistons stroke, driven by Brushless servomotors and regulated by operator panel.

The depositor is suitable for the dosing of masses with high viscosity content with or without inclusions.

MLR

Suitable for "points", "ribbon", "OneShot points" and "OneShot ribbon" dosings.

Rotor and valve servo-controlled rotation allows to dose the exact quantities of chocolate and cream filling.

Stator add rigidity to the rotor, to grant high dosing accuracy and protect the machine's housing from the abrasive corrosion of fondant fillings in the dosing products

# CORE

State-of-the-art piston depositors



Designed for tool-less replacement of the CORE Group (piston block, hopper, dosing plate and minipallet) and production change in less than 10 min.

STANDARD FEATURES

No contamination between different productions (white/dark chocolate, water/fat based cream or point/ribbon depositing), achievable only with one depositor, avoiding extended downtimes.

Completely removable and modular unit electronically driven, included head vertical movement servo driven.

Available in 650 and 1000 on our moulding line or stand alone versions.

AVAILABLE ALSO THE NEW AERO CORE VERSION FOR AERATED MASSES, WITH NEW AILP TECHNOLOGY (ALWAYS IN-LINE PISTONS)

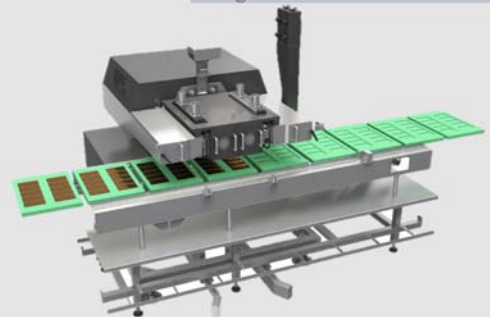
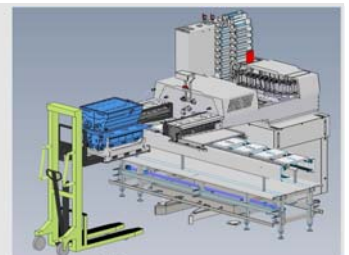

**SACMI Packaging & Chocolate S.p.A.**

Sede Legale: Via Selice Provinciale, 17/A - 40026 Imola (BO) Italy

Sede Amministrativa: Via Trebbia, 22 - 20089 Rozzano (MI) Italy

Tel. +39 0282452.1 - Fax +39 02 82452252

[www.cm-opm.it](http://www.cm-opm.it)